

## R-BRUSH Manual Plastic Brushes

Brush accessory for cleaning out holes prior to anchor installation



### Product information

#### Features and benefits

- Ideal for cleaning dust from drilled holes prior to applying bonded anchors or installing mechanical anchors
- Hole cleaning is necessary for correct loads
- Several embedment depths possible
- Suitable for repetitive and frequent use.

#### Applications

- For use in a wide range of fastening applications in concrete and solid masonry structures

### Installation guide

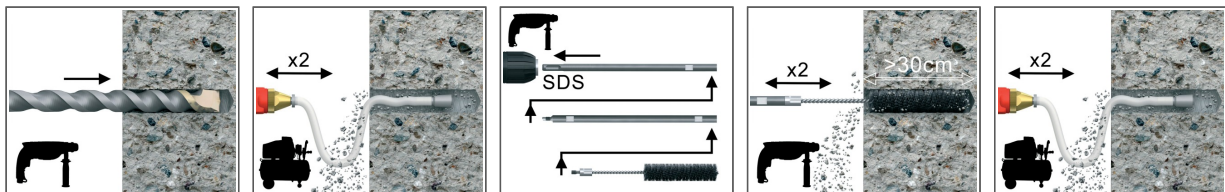

1. Drill hole to the required diameter and depth for stud size being used.
2. Before inserting anchor, clean inside of hole by compressed air starting from the drill hole bottom. Blow the hole at least twice by compressed air at minimum 6 bar.
3. Choose extensions and brushes to the selected depth and diameter of the hole, then combine them into one set.
4. Connect the drill set with the SDS tip.
5. Clean the hole twice with a prepared brush set.
6. Clean the hole again with compressed air.

## Product information

| Product Code   | Diameter | Stud size | Length | Working length | Material   | Raw material | Colour |
|----------------|----------|-----------|--------|----------------|------------|--------------|--------|
|                | D        |           | L      |                |            |              |        |
|                | [mm]     | -         | [mm]   |                |            |              |        |
| R-BRUSH-M08/10 | 15       | M8-M10    | 385    | 105            | Steel wire | Nylon        | WHITE  |
| R-BRUSH-M10/14 | 20       | M12-M14   | 385    | 105            | Steel wire | Nylon        | BLUE   |
| R-BRUSH-M16/28 | 30       | -         | 395    | 105            | Steel wire | Nylon        | RED    |

## Product commercial data

| Product Code   | Stud size | Length [mm] | Quantity [pcs] |       |        | Weight [kg] |       |        | Bar Codes     |
|----------------|-----------|-------------|----------------|-------|--------|-------------|-------|--------|---------------|
|                |           |             | Box            | Outer | Pallet | Box         | Outer | Pallet |               |
| R-BRUSH-M08/10 | M8-M10    | 385         | 1              | 1     | 3600   | 0.03        | 0.03  | 127.2  | 5906675130897 |
| R-BRUSH-M10/14 | M12-M14   | 385         | 1              | 1     | 3600   | 0.03        | 0.03  | 127.2  | 5906675127446 |
| R-BRUSH-M16/28 |           | 395         | 1              | 1     | 3600   | 0.06        | 0.06  | 246.0  | 5906675127453 |