

AT DIY Tool

Tool which pulls the screw head and expands the interset cavity fixing body



Product information

Features and benefits

- Fast and simple installation reduces working times
- No screwdriver needed

Applications

- Fixing light shelving, brackets and hooks
- Installation of ceiling fixtures, such as light fittings
- Cable trays
- Bathroom fittings

Installation guide

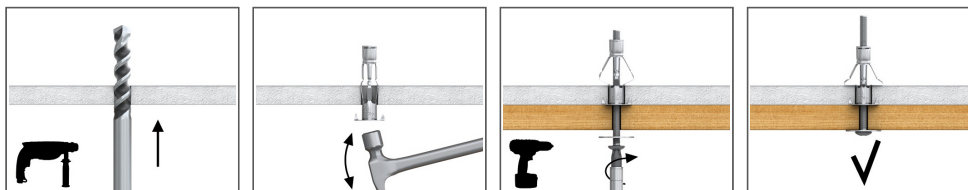

1. Drill a hole of required diameter.
2. Insert the fixing into the hole. Tap in lightly, ensuring that the anti-rotation lugs penetrate the face of the base material
3. With the hole drilled and the fixing inserted, the setting tool or screw driver is used to pull the screw head, thus expanding the fixing body

Product information

Product Code	Use
AT-88RAWL	Professional

Product commercial data

Product Code	Use	Quantity [pcs]			Weight [kg]			Bar Codes
		Box	Outer	Pallet	Box	Outer	Pallet	
AT-88RAWL	Professional	1	18	432	0.63	11.3	302.2	5906675906300