

SN Interaset Sleeve

Interaset fixing for permanent anchorages in cavity walls. Zinc-plated metal fixing.

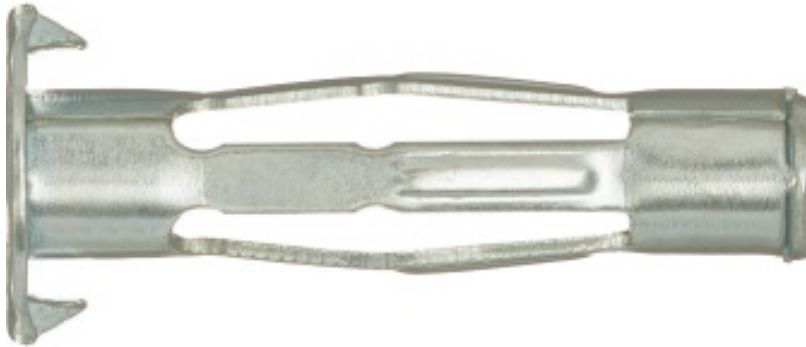

Product information

Features and benefits

- Combination head screw not supplied
- Integral anti-rotation lugs
- Hinged legs designed to maximise load-bearing capacity

Applications

- Shelves and bathroom accessories on standard plasterboard
- Radiators and kitchen cabinets on double thickness and tiled plasterboard
- Pictures
- Lamps
- Electric switches
- Towel rails
- Curtain rails
- Coat hooks on hollow doors

Base materials

Suitable for use in

- Plasterboard
- Gypsum Fibreboards
- Chipboard
- Oriented Strand Board

Installation guide

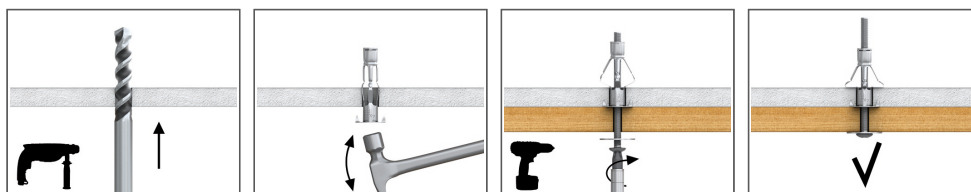

1. Drill a hole of required diameter.
2. Insert the fixing into the hole. Tap in lightly, ensuring that the anti-rotation lugs penetrate the face of the base material
3. With the hole drilled and the fixing inserted, the setting tool or screw driver is used to pull the screw head, thus expanding the fixing body

Product information

Product Code	Steel sleeve		
	Diameter	Minimum clearance	
	D	A	B
	[mm]		
R-SN-04038	8	25	8
R-SN-04046	8	26	7
R-SN-05037	10	27	9
R-SN-05052	10	40	13
R-SN-06037	12	27	8
R-SN-06052	12	38	13
R-SN-06065	12	38	13
R-SN-08065	14	-	-

Installation data

Size			M4	M5	M6	M8
Hole diameter in substrate	d_o	[mm]	8	10	12	14
Min. spacing	s_{min}	[mm]	25	25	25	30
Min. edge distance	c_{min}	[mm]	25	25	25	30
Min. substrate thickness	h_{min}	[mm]	-	9.5	9.5	12.5

Product commercial data

Product Code	Quantity [pcs]			Weight [kg]			Bar Codes
	Box	Outer	Pallet	Box	Outer	Pallet	
R-SN-04038	100	1800		0.00	0.00		5906675224015
R-SN-04046	100	1800		0.00	0.00		5906675172620
R-SN-05037	100	1800		0.00	0.00		5906675172644
R-SN-05052	100	1200		0.00	0.00		5906675172668
R-SN-06037	100	1200	28800	1.76	21.1	536.9	5906675172682
R-SN-06052	100	1200	28800	2.3	27.0	678.0	5906675172705
R-SN-06065	100	1200	28800	1.16	13.9	364.1	5906675172729
R-SN-08065	100	100	19600	1.58	1.58	339.7	5906675239606