

Rawlplug® Rawl® UNO® MULTI-PURPOSE ANCHOR WITH SCREW

Truly universal plug which fixes into any base material, solid or hollow.



Product information

Features and benefits

- 100% assurance of proper anchoring derived from unique split design of the plug in its top part.
- Anti-rotation features prevent spinning in the hole.
- Lip prevents plug slipping into over-sized holes.
- Unique geometry guarantees maximum expansion and grip.
- Short length enables successful use in thin walls.
- Recommended for unknown substrates and exploited holes.

Applications

- Shelves
- Suspended ceilings
- Electrical fittings
- Cable trays
- Boilers
- Radiators
- Lighting
- Bathroom fittings

Base materials

Suitable for use in

- Concrete
- Solid Brick
- Solid Sand-lime Brick
- Vertically-perforated Clay Block
- Hollow Sand-lime Brick
- Aerated Concrete Block
- Plasterboard

Installation guide

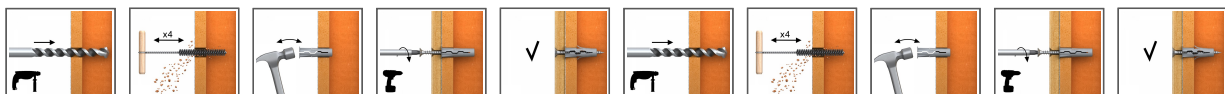

1. Drill a hole of required diameter.
2. Insert UNO plug into hole and tap home.
3. Insert screw of required diameter into plug through fixture and tighten.
4. Drill a hole of required diameter.
5. Insert UNO plug into hole and tap home.
6. Insert screw of required diameter into plug through fixture and tighten.

Product commercial data

Product Code	Quantity [pcs]			Weight [kg]			Bar Codes
	Box	Outer	Pallet	Box	Outer	Pallet	