

Rawlplug® Rawl® RAWLANCHOR EXCELLENT ANCHOR FOR HOLLOW WALLS

Inter-set fixing for permanent anchorages in cavity walls. Zinc-plated metal fixing with metric screw



Product information

Features and benefits

- Due to extensive range the SM INTERSET is suitable for board building materials with a thickness 2-38mm, it allows for a number of different applications.
- The fixing can be installed using normal screwdriver, or installation pliers.
- One piece stamping, with integral thread and flange for increased reliability.
- Hinged legs designed to maximise load-bearing capacity
- Large contact area of expanded arms increases load-bearing capacity and security.
- Integral anti-rotation lugs
- Fixtures can be removed and re-fitted.
- Combination head screw supplied

Base materials

- Suitable for use in**
- Plasterboard
 - Gypsum Fibreboards
 - Chipboard
 - Oriented Strand Board

Installation guide

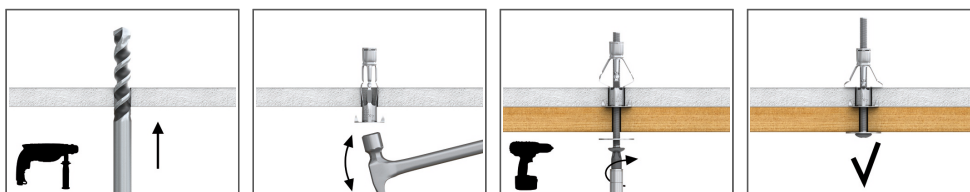

1. Drill a hole of required diameter.
2. Insert the fixing into the hole. Tap in lightly, ensuring that the anti-rotation lugs penetrate the face of the base material
3. With the hole drilled and the fixing inserted, the setting tool or screw driver is used to pull the screw head, thus expanding the fixing body

Product information

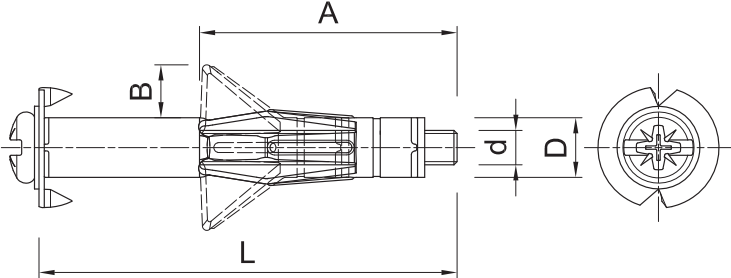

Size	Product Code
------	--------------

Product commercial data

Product Code	Quantity [pcs]			Weight [kg]			Bar Codes
	Box	Outer	Pallet	Box	Outer	Pallet	