

FIX EXPANSION PLUG WITH COCHLEAR HOOK

Easy-to-install plug with cochlear hook giving exceptional performance in solid base materials.



Product information

Features and benefits

- Anti-rotation fins prevent spinning during tightening of the screw.
- Engineered grip feature for extra holding power.
- Two-way expansion mechanism provides a strong anchorage in solid base materials.
- Cochlear hook for many application scenarios

Applications

- Swing
- Lighting

Base materials

- Approved for use in:**
- Concrete

Installation guide

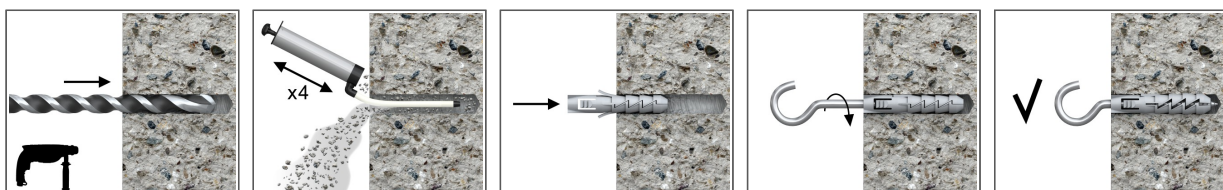

1. Drill a hole of required diameter.
2. Insert FIX plug into hole and tap home.
3. Insert screw of required diameter into plug through fixture and tighten.

Product information

Size	Product Code	Plug		Screw	
		Diameter	Length	Diameter	Length
		d	l	D	L
[mm]					
Ø12	FIX-12H	12	60	8	130

Installation data

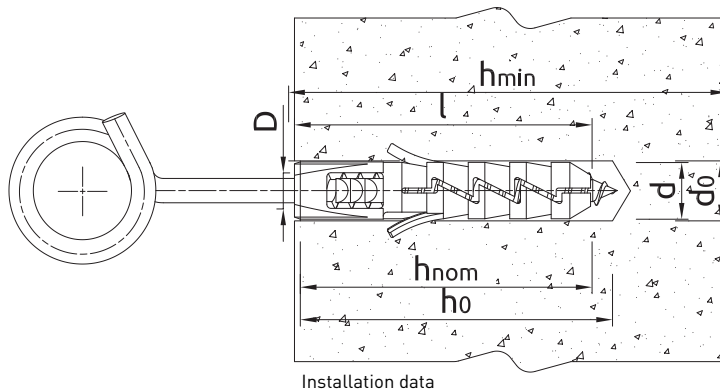

Size	Ø12		
Hole diameter in substrate	d_0	[mm]	12
Min. hole depth in substrate	h_0	[mm]	70
Min. installation depth	h_{nom}	[mm]	60
Min. substrate thickness	h_{min}	[mm]	90
Min. spacing	s_{min}	[mm]	120
Min. edge distance	c_{min}	[mm]	120
Fixing diameter	d	[mm]	12

Basic performance data

Performance data for single fixing without influence of edge distance and spacing

Substrate	Concrete C20/25 - C50/60	Solid clay brick min 20MPa (eg Mz20/2.0)	Sand-time solid brick	Aerated concrete 600 Mark V
CHARACTERISTIC LOAD				
TENSION LOAD N_{Rk}				
Ø12, Embedment depth 60mm	[kN] 1.20	1.20	1.25	1.25
SHEAR LOAD V_{Rk}				
Ø12, Embedment depth 60mm	[kN] 1.20	1.20	3.00	2.00
DESIGN LOAD				
TENSION LOAD N_{Rd}				
Ø12, Embedment depth 60mm	[kN] 0.67	0.48	1.00	1.00
SHEAR LOAD V_{Rd}				
Ø12, Embedment depth 60mm	[kN] 0.96	0.96	2.40	1.60
RECOMMENDED LOAD				
TENSION LOAD N_{rec}				
Ø12, Embedment depth 60mm	[kN] 0.48	0.34	0.71	0.71
SHEAR LOAD V_{rec}				
Ø12, Embedment depth 60mm	[kN] 0.69	0.69	1.71	1.14

Product commercial data

Product Code	Plug	Screw	Quantity [pcs]			Weight [kg]			Bar Codes
	Diameter [mm]	Length [mm]	Box	Outer	Pallet	Box	Outer	Pallet	
FIX-12H	12	130	25	300	7200	1.36	16.3	422.3	5906675081229