

WX Self-drilling screws for steel

Screw for trapezoidal steel sheet – max thickness of 2 x 1.25mm, PH2 drive



Approvals and Reports

- ETA-09/0346
- UKTA-22/6338



Product information

Features and benefits

- Hardened thread surface
- High quality anti-corrosion coating guarantees resistance of 15 Kesternich cycles.
- Shape and type of the thread specially design to allow connecting to metal sheets
- The drill point is designed to provide a fast and hassle-free installation. Sharp point of the drill prevents movement of the surface of the fixture.
- Reduced drilling point ensures optimal tightness and correct hole diameter in thin metal sheets.
- Pre-assembly with other components is possible before installation

Applications

- Insulation layers on flat roofs together with a appropriate telescopic or steel washer

Base materials

- Approved for use in:**
- Metal Sheet & Profiles

Installation guide

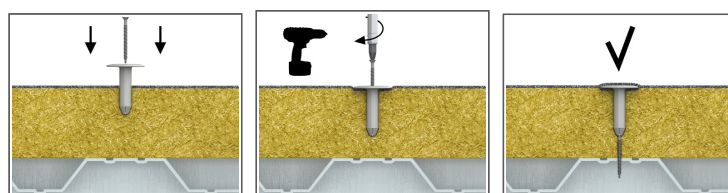

1. Lightly insert plastic sleeve into insulation material
2. Using drilling machine, drive the WX screw into substrate until fixing depth is reached

Product information

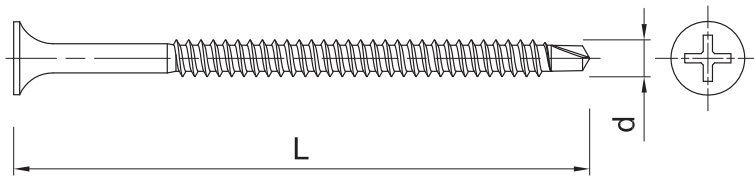

Size	Product Code	Screw		Fixture
		Diameter	Length	Max. thickness
		d	L	t _{fix}
[mm]				
Ø4.8	R-WX-48050	4.8	50	70
	R-WX-48060	4.8	60	80
	R-WX-48070	4.8	70	90
	R-WX-48080	4.8	80	100
	R-WX-48100	4.8	100	110
	R-WX-48120	4.8	120	250
	R-WX-48140	4.8	140	270
	R-WX-48160	4.8	160	290
	R-WX-48180	4.8	180	310
	R-WX-48200	4.8	200	330
	R-WX-48240	4.8	240	370
	R-WX-48300	4.8	300	430

Installation data

Size	15.5		
Hole diameter in substrate	d ₀	[mm]	-
Min. hole depth in substrate	h ₀	[mm]	-
Min. installation depth	h _{nom}	[mm]	-
Min. substrate thickness	h _{min}	[mm]	0.63
Min. spacing	s _{min}	[mm]	120
Min. edge distance	c _{min}	[mm]	30
Screw diameter	d	[mm]	4.8
Substrate			Steel
			Product,

Product commercial data

Product Code	Screw	Quantity [pcs]			Weight [kg]			Bar Codes
	Length [mm]	Box	Outer	Pallet	Box	Outer	Pallet	
R-WX-48050 ¹⁾	50	250	3000	72000	1.10	13.2	346.8	5906675175140
R-WX-48060 ¹⁾	60	250	3000	72000	1.39	16.7	430.3	5906675175164
R-WX-48070 ¹⁾	70	250	3000	72000	1.61	19.3	493.7	5906675175188
R-WX-48080 ¹⁾	80	250	3000	72000	1.89	22.7	574.3	5906675175201
R-WX-48100 ¹⁾	100	200	2400	57600	1.85	22.2	562.8	5906675175225
R-WX-48120 ¹⁾	120	200	2400	57600	2.2	26.5	666.5	5906675175249
R-WX-48140 ¹⁾	140	200	2400	57600	2.6	30.8	770.2	5906675175263
R-WX-48160 ¹⁾	160	100	1200	28800	1.50	17.9	460.6	5906675175287
R-WX-48180 ¹⁾	180	100	100	16800	1.67	1.67	310.6	5906675175300
R-WX-48200 ¹⁾	200	100	100	16800	1.85	1.85	340.8	5906675175324
R-WX-48240 ¹⁾	240							
R-WX-48300 ¹⁾	300	100	100	16800	2.8	2.8	491.2	5906675175348

1) ETA-09/0346