

R-PLS Plastic Mesh Sleeves

The sleeve for reduced mortar consumption and optimal mechanical interlock

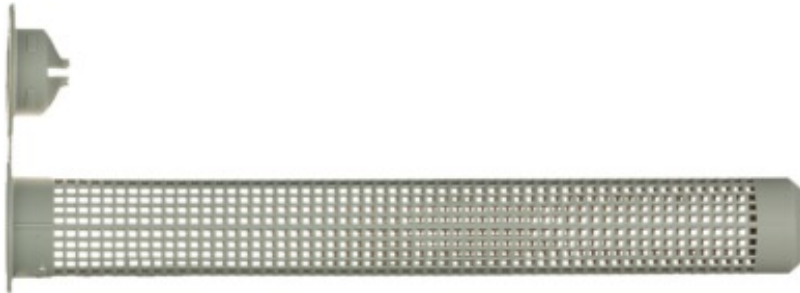

Product information

Features and benefits

- Ensures that the anchor rod is properly centred
- Reduces consumption of resin
- User-friendly installation in hollow substrates
- Size must be adjusted to the hole depth and diameter
- Hole cleaning is not necessary

Applications

- For use with R-STUDS threaded rods in hollow base materials
- [English]: Stosowana w podłożach pustych.

Installation guide

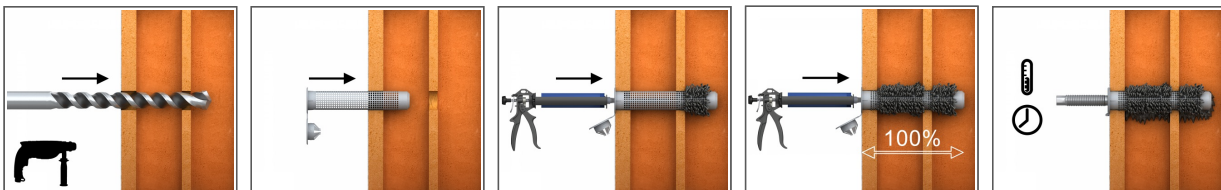

1. Drill the hole and clean it up.
2. Insert the sleeve in the hole.
3. Apply the resin in 100 % of depth of the hole and close the cap.
4. Place the stud in the sleeve and wait until full curing of the resin, as stated on the product label.
5. After full curing of the anchor, install the fixed element with proper torque.

Product information

Product Code	Plastic mesh sleeve size [mm]	Stud size -	Hole diameter	Raw material -	Colour -
			d [mm]		
R-PLS-16085-10	16x85	M10-M12	16	polypropylene	transparent
R-PLS-16130-10	16x130	M12	16	polypropylene	transparent
R-PLS-20085-10	20x85	M16	20	polypropylene	transparent
R-PLS-12050-10	12x50	M8	12	polypropylene	transparent
R-PLS-12050	12x50	M8	12	polypropylene	transparent
R-PLS-16085	16x85	M10-M12	16	polypropylene	transparent
R-PLS-16130	16x130	M12	16	polypropylene	transparent

Product commercial data

Product Code	Stud size	Hole diameter [mm]	Quantity [pcs]			Weight [kg]			Bar Codes
			Box	Outer	Pallet	Box	Outer	Pallet	
R-PLS-16085-10	M10-M12	16	10	500	6000	0.03	1.45	47.4	5906675347547
R-PLS-16130-10	M12	16	10	400	4800	0.06	2.6	60.7	5906675347554
R-PLS-20085-10	M16	20	10	400	4800	0.04	1.68	50.2	5906675291864
R-PLS-12050-10	M8	12	10	700	8400	0.02	1.40	46.8	5906675377520
R-PLS-12050	M8	12	5000	5000	105000	6.0	6.0	156.0	5906675329925
R-PLS-16085	M10-M12	16	2000	2000	42000	5.8	5.8	151.8	5906675329949
R-PLS-16130	M12	16	1200	1200	25200	5.3	5.3	140.9	5906675329932