

R-NOZ Mixer Nozzle

Static mixer for bonded anchors in cartridges and CFS+ system

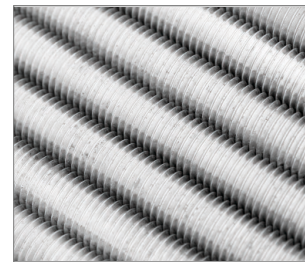

Product information

Features and benefits

- Convenient extrusion and mixing of resin and hardener
- Available with or without hanger
- Ideal for serial applications: rebar or anchoring
- Specially dedicated nozzle fits for anchoring systems R-KEM II, R-KER, R-CFS+
- Possibility of extension- attach SP-CE-ED-1m extension nozzle

Applications

- For use in a wide range of fastening applications in concrete and solid masonry structures

Installation guide



1. Simply screw the mixer nozzle onto the resin cartridge (after removing cap) or CFS+ system
2. Before inserting nozzle to the hole inject resin until even colour is obtained
3. Insert mixing nozzle to the far end the hole and inject resin, slowly withdrawing the nozzle

Product information

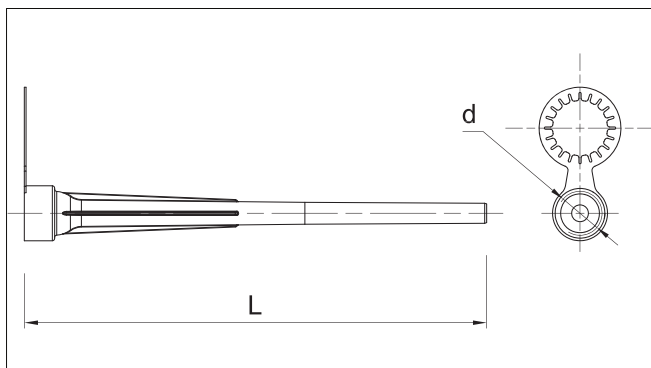

| Product Code | Length | | Diameter |
|----------------|--------|----------------------------------|----------|
| | L | | D |
| | [mm] | - | [mm] |
| R-NOZ-10 | 200 | 10 element Mixer Nozzle | - |
| R-NOZ-20 | 200 | 10 element Mixer Nozzle | - |
| R-NOZ-100/100 | 200 | 10 element Mixer Nozzle | - |
| R-NOZ-EXT-200 | 200 | Extension for mixer nozzle R-NOZ | 9.5 |
| R-NOZ-EXT-300 | 300 | Extension for mixer nozzle R-NOZ | 9.5 |
| R-NOZ-EXT-3000 | 3000 | Extension for mixer nozzle R-NOZ | 12 |
| SP-CE-ED-1M | 1000 | Extension for mixer nozzle R-NOZ | 12 |

Product commercial data

| Product Code | Length [mm] | Quantity [pcs] | | | Weight [kg] | | | Bar Codes |
|----------------|-------------|----------------|-------|--------|-------------|-------|--------|---------------|
| | | Box | Outer | Pallet | Box | Outer | Pallet | |
| R-NOZ-10 | 200 | 10 | 200 | 4800 | 0.08 | 1.50 | 66.0 | 5906675127460 |
| R-NOZ-20 | 200 | 20 | 200 | 4800 | 0.16 | 1.62 | 68.9 | 5906675379906 |
| R-NOZ-100/100 | 200 | 100 | 700 | 16800 | 0.78 | 5.5 | 161.0 | 5010445606427 |
| R-NOZ-EXT-200 | 200 | 50 | 1000 | | 0.20 | 4.0 | | 5906675423357 |
| R-NOZ-EXT-300 | 300 | 50 | 50 | 10800 | 0.30 | 0.30 | 94.8 | 5906675423517 |
| R-NOZ-EXT-3000 | 3000 | 1 | 1 | | 0.06 | 0.06 | | 5906675430041 |
| SP-CE-ED-1M | 1000 | 10 | 10 | 20000 | 0.28 | 0.28 | 590.0 | 5906675601120 |