

R-FTC Drywall collated screws for wood

Coarse thread screws for fixing plasterboards to wooden framing

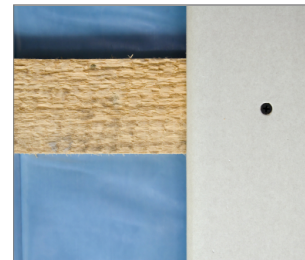
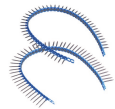

Approvals and Reports

PN-EN 14566 + A1: 2012

DoP-EN14566

Reaction to fire: A1

Flexural strength: pass

CE
10

Product information

Features and benefits

- Top-quality material and dimensional accuracy of the collating strip for improved firmness and stability of screw feeding into the screwdriver ensuring minimised screw jamming or skipping risk
- Optimised screw tip geometry - excellent drilling capability
- No pre-drilling required
- Low-carbon steel with black phosphate finish for increased durability
- Bugle head with PH2 drive designed to finish flush with plasterboard

Applications

- Fastening plasterboard walls to wooden framework

Base materials

Approved for use in:

- Wood

Installation guide

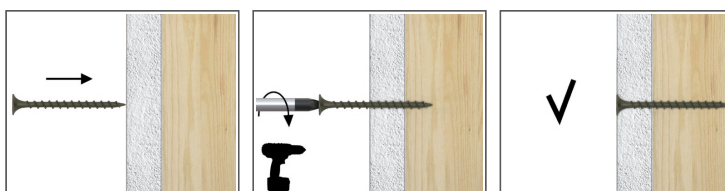

1. Drive the screw straight until the head is flush
2. Screws with countersunk head allow flush connection

Product information

Size	Product Code	Screw		Fixture
		Diameter	Length	Max. thickness
		d	L	t _{fix}
		[mm]	[mm]	[mm]
Ø3.5	R-FTC-3535	3.5	35	18
	R-FTC-3538	3.5	38	21
	R-FTC-3545	3.5	45	28
	R-FTC-3555	3.5	55	38
	R-FTC-3525	3.5	25	18

Installation data

Size			Ø3.5
Substrate			Timber
Min. installation depth	h _{nom}	[mm]	14
Min. substrate thickness	h _{min}	[mm]	28
Min. spacing	s _{min}	[mm]	30
Min. edge distance	c _{min}	[mm]	30

Basic performance data

Performance data for single screw without influence of edge distance and spacing

Size			Ø3.5
Substrate			Steel
Substrate thickness h _{min}	[mm]		0.5
CHARACTERISTIC LOAD F _{RK}			
FT F _{Rk}	-		0.55
DESIGN LOAD F _{RD}			
FT F _{Rd}	-		0.29
RECOMMENDED LOAD F _{REC}			
FT F _{rec}	-		0.21

Product commercial data

Product Code	Screw	Quantity [pcs]			Weight [kg]			Bar Codes
	Length [mm]	Box	Outer	Pallet	Box	Outer	Pallet	
R-FTC-3535	35	1000.0	10000.0	180000.0	1.93	19.3	377.2	5906675486611
R-FTC-3538	38	1000.0	10000.0	1000000.0	2.1	20.9	3366.0	5906675486628
R-FTC-3545	45	1000.0	8000.0	1000000.0	2.3	18.7	3769.2	5906675486635
R-FTC-3555	55	1000.0	6000.0	1000000.0	2.8	16.6	4452.4	5906675486642
R-FTC-3525	25	1000.0	12000.0	216000.0	1.54	18.4	361.6	5906675192925